

Revisions	Date
Add 40409	6-25-88
Conform to HF	3-91

DIST.	COUNTY	ROUTE	SECTION	SHEET NO.	TOTAL SHEETS
IV	S.C.L.	2	B	(101)	

No.	Grantor	Area Acquired (A.C.±)	Recordation		
			Type	Date	Page
60	Kate Coffin	3,012	F	13-18-37	816
61	Sebastiano Lg. Barbera	1,669	F	10-4-37	816
62	Domingos T. Borja et ux	0,031	F	3-2-37	815
63	Mary J. Van Every	4,663	F	19-28-37	816
64	M. Pimentel et ux	1,998	F	12-17-37	856
40409	State to City of San Jose		Relinquishment	6-25-88	1163

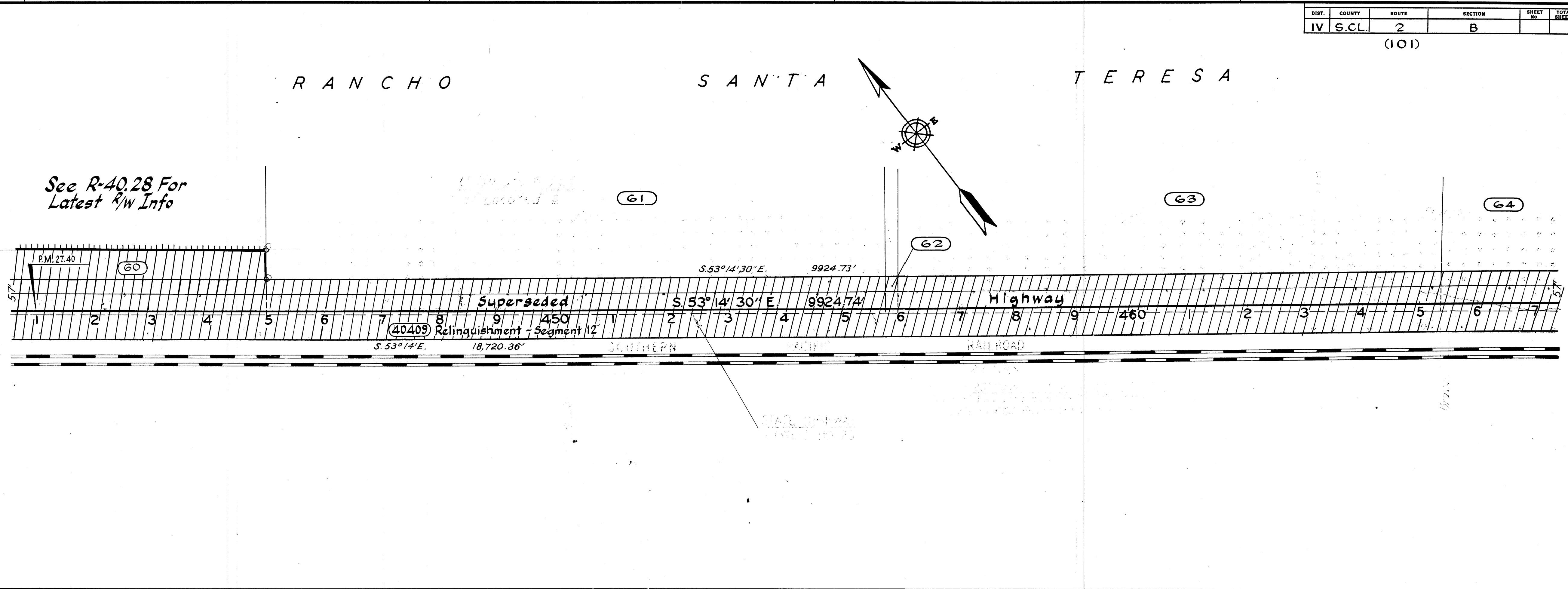

REVISIONS	DATE
Add 40416	11-9-88
Add 40409	6-25-88
Conf to HF	3-91

DIST.	COUNTY	ROUTE	SECTION	SHEET NO.	TOTAL SHEETS
IV	S.C.L.	2	B	(101)	

No.	Grantor	Area Acquired (A.C.±)	Recordation		
			Type	Date	Page
64	M. Pimentel et ux	1,998	F	12-17-37	856
65	O. N. Featherston	1,401	F	2-19-37	809
66	Victoria Oliva	1,391	F	7-28-37	833
40416	State to City of San Jose		Relinquishment	11-9-88	1160
40409	State to City of San Jose		Relinquishment	6-25-88	1163

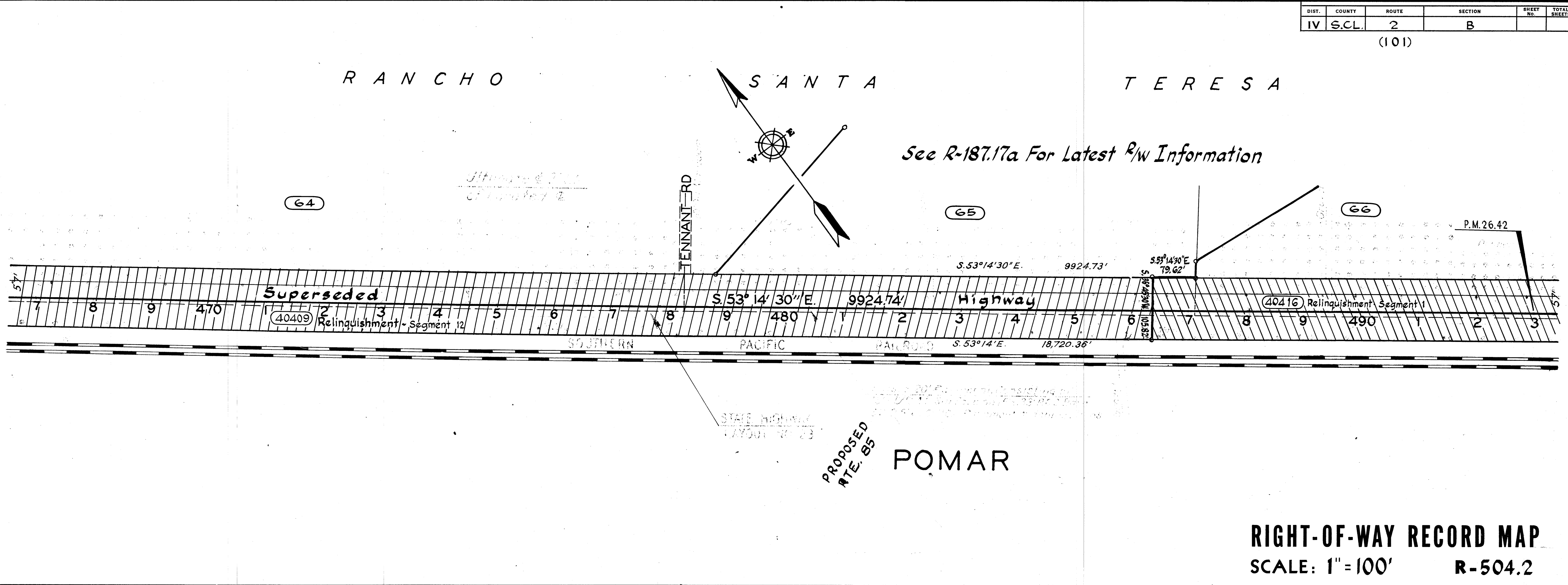

PROPOSED R/W E. 85

POMAR

RIGHT-OF-WAY RECORD MAP  
SCALE: 1" = 100'  
R-504.2

R504004 (101)